



# Quick Reference Card

Please consult your spa user manual for complete info on the features of your spa system.

## in.k600™

Advanced series of full-function keypads that give complete control to wet fingers!

Aeware's® new series of keypads features a high profile with a large LCD display, menu-driven interface that let users easily control all in.xm™ functions and programming directly from spa side, creating a true and unique user experience.

### Description

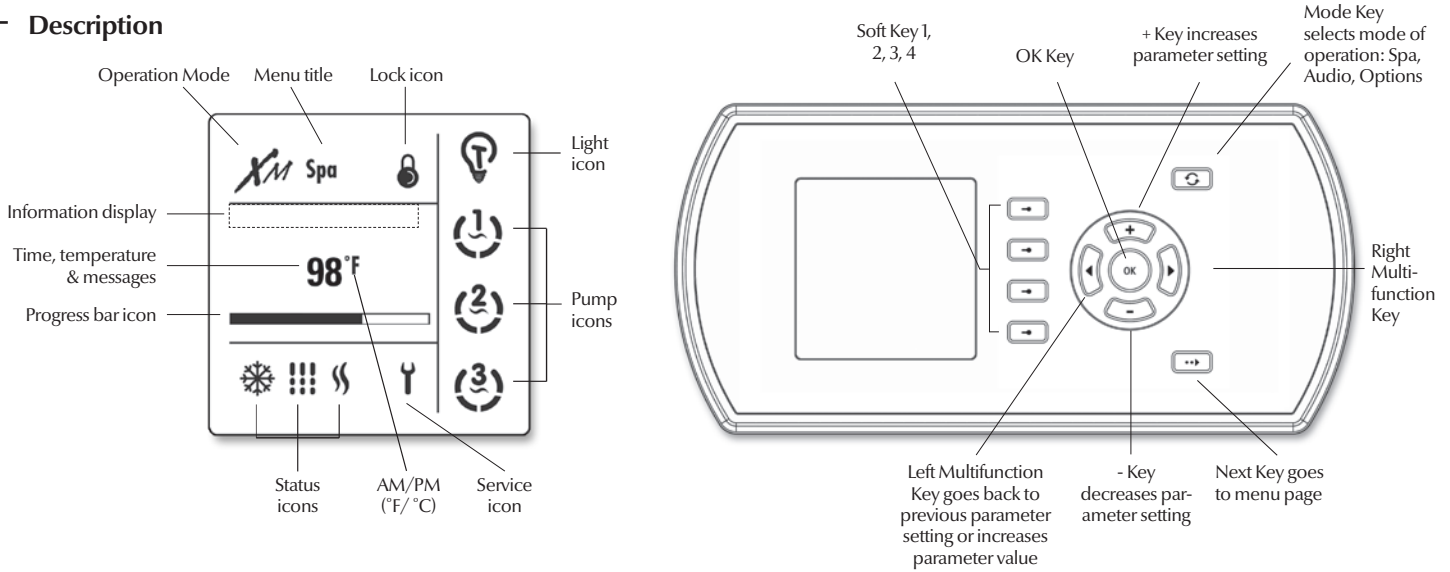

### Main functions

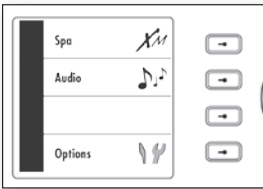

This menu allows control of all pumps, blower, and spa light, as well as the activation of the Economy and Standby modes. Animated icons are displayed when devices are on. All pump activity can be stopped at once by activating the Standby mode.



• Press Mode key to display the mode Selection window.

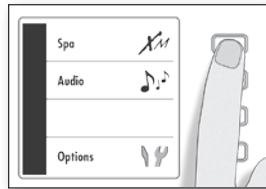

• Select Spa to view Spa menu.

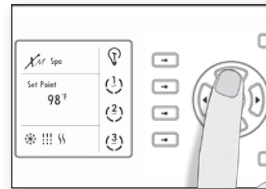

#### Water temperature settings

- Press Plus/Minus keys to select water temperature setting.
- Press OK or wait 5 seconds to confirm new setting. The "Set Point" prompt indicates the desired temperature NOT the current water temperature.

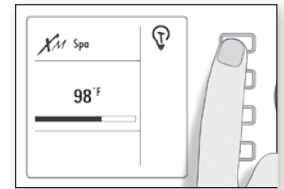

#### Light

- Select Light key to turn light on.
- Select Light key repeatedly to control light intensity. A final selection turns light off. (120 minute built-in timer)



#### Starting all accessories\*

- Press the Quick On/Off button to start all accessories (pumps and turbines) in high speed.
- Press the Quick On/Off button again to stop all accessories (pumps and turbines). There is an integrated 120 minute timer.



#### Starting Pump 1

- Select Pump 1 to turn Pump 1 on.
- Select Pump 1 repeatedly to control pump 1 speed. (20 minute built-in timer)

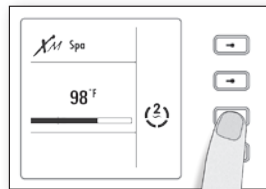

#### Starting Pump 2\*

- Select Pump 2 to turn Pump 2 on.
- Select Pump 2 repeatedly to control pump 2 speed. (20 minute built-in timer)

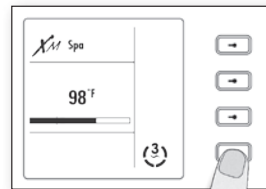

#### Starting Pump 3\*

- Select Pump 3 to turn Pump 3 on.
- Select Pump 3 once more to turn pump 3 off. (20 minute built-in timer)

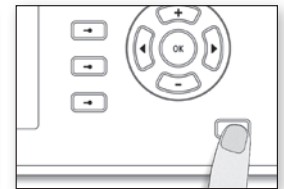

#### Next menu page

- Press Next key to display the next page in the spa menu. Goes to blower option

\*option available depending upon factory settings

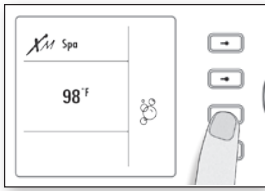

### Starting Blower\*

- Press **Blower** to turn Blower on.
  - Press **Blower** once more to turn blower off.
- (20 minute built-in timer)

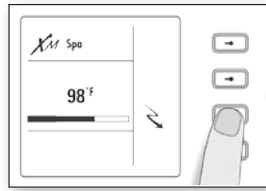

### Economy Mode

- Lowers the temperature set point of the spa by 20°F (11°C).
- Select **Economy** to activate the Economy mode.
  - Select **Economy** again to override economy programming (see spa setup section).

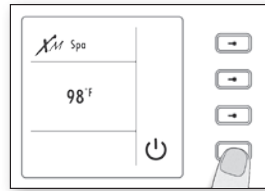

### Standby Mode

Stops all pumps at the same time by a simple click of a button!

- Press **Standby** to activate this mode.
- Press **Standby** again to resume normal operations.

System automatically returns to Normal mode after a certain period of time, unless the Standby mode has been reactivated. Spa light will flash for a few seconds before the exit of Standby mode and restart the pumps. The "Standby" message is also displayed during Standby mode.

\* Pump will stay turned on if there is a request for more heat.

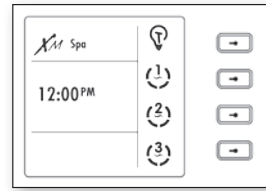

### Displaying time

- Press **OK** key to display the time.
- Press **OK** key a second time to go back to water temperature display.

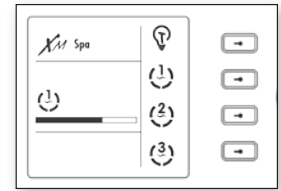

### Viewing active progress bars

A progress bar is a visual indicator of the time remaining before a device is turned off. Only one bar is displayed at the time.

- Use **Left** or **Right** keys to visualize the progress bar of each activated device.

## Programming

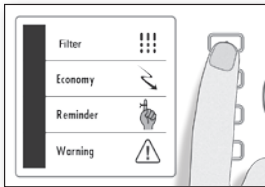

### Programming the spa system

To program the filter cycle, you must enter these parameters: start time, duration and frequency. During a filter cycle, pumps run for one minute to purge the plumbing, then Pump 1 runs for the programmed number of hours.

- Press **Mode** key
- Select **Options** menu
- Select **Spa** sub-menu
- Select **Filter** option

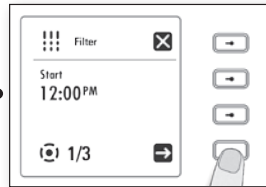

### Setting filter cycle start time

The display will show the starting hour previously set.

- Use (+) or (-) key to select hour setting.
- Use **Right** key to set minutes.
- Use (+) or (-) key to change minutes.
- Select **Next arrow**  on screen menu to go to the next parameter: filter cycle duration.



### Setting cycle duration

Here we set a value for the filter cycle duration, in hours and minutes.

- Use (+) or (-) key to set hour.
- Use **Right** key to set minutes.
- Use (+) or (-) key to change minutes.
- Select **Next arrow**  on screen menu to save changes and go to the next parameter: filter cycle frequency.

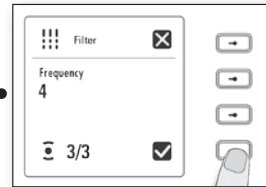

### Setting filter cycle frequency

Here we set the number of filtering cycles that the system will perform per day.

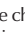
- Use (+) or (-) key to select frequency setting.
- Select **Enter**  to save changes and go back to spa options main menu.

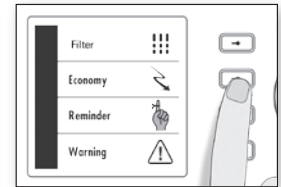

### Setting Economy mode\*

- Select **Economy**





### Setting Economy status

- Use (+) key to enable the economy mode, the display will show **On**.
- Use (-) key to disable economy mode, the display will show **Off**.



### Setting Economy start time

- Select **Next arrow**  to save changes and go to economy cycle start hour.
- Use (+) or (-) key to set hour setting.
- Use **Left** key to access minutes option.
- Use (+) or (-) key to set minutes.
- Select **Next arrow**  to save changes and go to the next parameter stop economy.

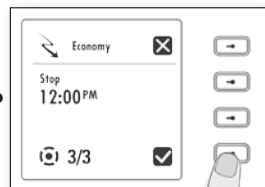

### Setting Economy stop time

- Use (+) or (-) key to set hour.
- Use **Left** key to access minutes option.
- Use (+) or (-) key to set minutes.
- Select **Enter** option  to save changes and go back to spa options menu.

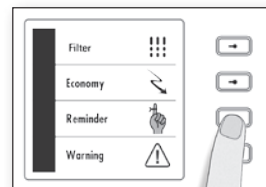

### Setting maintenance reminder prompts

This menu allows you to activate/deactivate or simply reset the maintenance reminder prompts.

- Select **Reminder** option

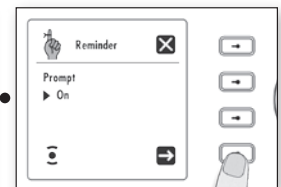

### Turning reminders on/off\*

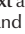
- Use (+) or (-) key to activate or deactivate prompt(s).
- Select **Next arrow**  to save changes and go to next menu screen.



#### Resetting prompt messages

- Use **Left** or **Right** keys to review one by one all active maintenance messages.
- Select **Enter**  to reset message and view next task or go back to main menu.

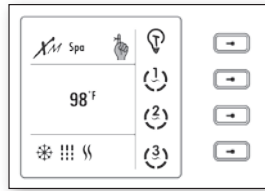

#### Viewing spa reminders

The reminder icon will show up when you have active maintenance messages.

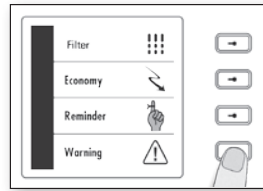

#### Spa warnings

This menu allows you to view all active warning messages i.e. hot water.

- Select **Warning** option



#### Turning warnings on/off

- Use **Left** or **Right** keys to review all warning messages.
- Press **Mode** key again to go back to main menu.

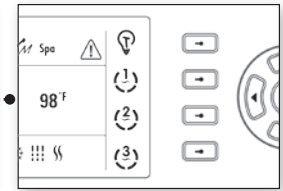

#### Viewing spa warnings

The warning icon shows up to prompt you to review active warning messages.

## Time setting

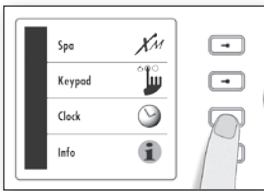

#### Setting the time

- Press **Mode** key
- Select **Options** menu
- Select **Clock** setting

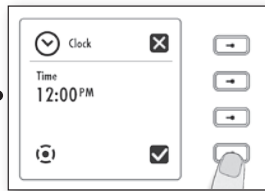

#### Setting hour settings

- Use (+) or (-) key to set hour.
- Use **Left** or **Right** key to access minutes option.
- Use (+) or (-) key to set minutes.
- Select **Enter**  to go back to the keypad main menu.

## Other settings



#### To program keypad settings

- Press **Mode** key
- Select **Options** menu
- Select **Keypad** sub-menu

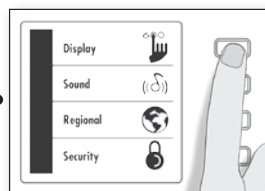

#### Setting keypad display options

This sub-menu is used to set keypad display settings such as contrast, backlight, etc.

- Select **Display** options

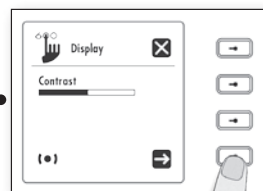

#### Adjusting contrast

- Use **Left** or **Right** keys to adjust desired level of contrast.
- Select **Next arrow** on display to save changes and go to next screen menu.

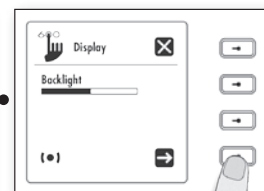

#### Adjusting backlight

- Use **Left** or **Right** keys to adjust backlight brightness.
- Select **Next arrow** on display to save changes and go to next screen menu.

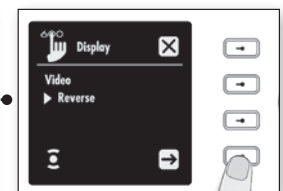

#### Normal/Reverse display

- Use (+) or (-) key to activate or deactivate reverse display.
- Select **Next arrow** on display to save changes and go to next screen menu.

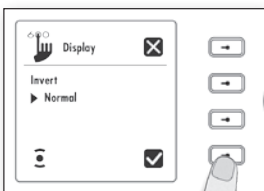

#### Display orientation (inverting)

- Use (+) or (-) key to activate or deactivate inverted display.
- Select **Enter** option  on screen menu to back to keypad main menu.



#### Setting keypad audio options

This sub-menu is used to set keypad audio options such as: keypad on (key beep) and alarm.

- Select **Sound** options

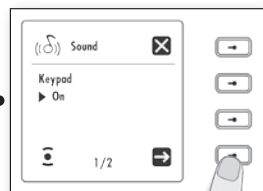

#### Keypad beep on/off

- Use (+) or (-) key to activate or deactivate the keypad beep.
- Select **Next arrow** on display to save changes and go to next screen menu.



#### Alarm sound

- Use (+) or (-) key to activate or deactivate alarm sound.
- Select **Enter**  to save changes and go back to main menu.



#### Setting regional settings

This sub-menu is used to set keypad regional settings such as language, temperature display units and format for time display.

- Select **Regional** options

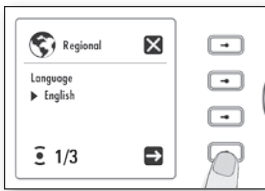

### Language

- Use (+) or (-) to select from: English, Français, Español & Deutsch
- Select Next arrow → on display to save changes and go to next screen menu.

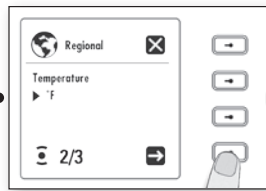

### Temperature units

- Water temperature can be displayed in °F or °C.
- Use (+) or (-) to change setting.
  - Select Next arrow → on display to save changes and go to next screen menu.

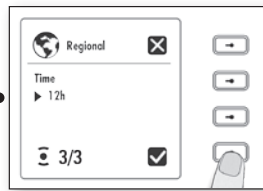

### Time format

- Use (+) or (-) to change setting.
- Select Enter ✓ on the screen menu to save changes and go back to keypad main menu.

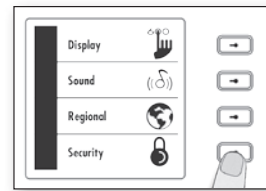

### Security options

Partial keypad lock: basic functions of the spa remain accessible (pump and light outputs), but it is impossible to change the temperature Set Point, or to enter programming mode. Full lock: all keys are disabled. When the keypad is locked, the icon will be displayed.

- Select Security options

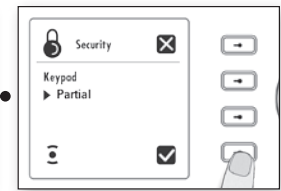

### Partial keypad lockout

- Use (+) or (-) key to select "Partial".
- Select Enter ✓ to go back to the keypad main menu.

To unlock the keypad:

- Select Mode key
- Press and hold Option key for 5 seconds



### Full keypad lockout

- Use (+) or (-) key to select "Full".
- Select Enter ✓ to go back to keypad main menu.

To unlock the keypad, press and hold the Light key for 5 seconds.

## System info

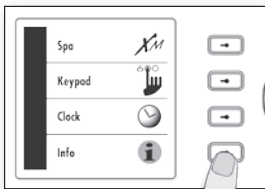

### Viewing information about the system

To view spa equipment data and keypad software version, and to reset programmed settings and to upgrade keypad software.

- Press Mode key
- Select Options menu
- Select Info sub-menu

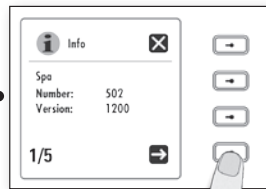

### Viewing information about spa

Spa software ID number and version are displayed.

- Select Next arrow → on display to next screen menu.

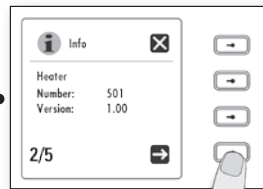

### Viewing information on heater software

Heater software ID number and version are displayed.

- Select Next arrow → on display to next screen menu.

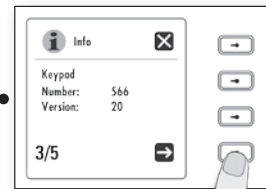

### Viewing information on keypad software

Keypad software ID number and version are displayed.

- Select Next arrow → on display to next screen menu.

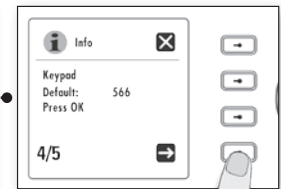

### Resetting keypad programmed values

- Press OK to reset back to default factory values.
- Select Next arrow → on display to next screen menu.



### Upgrading keypad software

- Use OK key to start the upgrade of the keypad software
- Select Enter ✓ to go back to the keypad main menu and cancel software upgrade.

